



Thank you for choosing our flooring. When properly installed and cared for, your new flooring will be easy to maintain and will keep its great look for years. The Area Floors SPC features an attached underlayment pad that is designed for a floating installation method and can be installed over existing floors provided they meet subfloor requirements listed below. The flooring is intended for interior use only and is suitable for above-grade, on-grade and below grade applications. The floors should not be installed in locations where the substrate below the building structure is exposed to the elements or where there are structural problems related to ongoing moisture exposure.

**INSTALLER/OWNER RESPONSIBILITY** Please read all the instructions before you begin the installation. Improper installation will void warranty.

#### **I. GENERAL PREPARATIONS**

**TOOLS REQUIRED:** Spacers, rubber mallet, ruler, pencil, tape measure, utility knife.

- Prior to installation, inspect material in daylight for visible faults/damage, including defects or discrepancies in color or shine; check the edges of the flooring for straightness and any damage. No claims on surface defects will be accepted after installation.
- It is preferable to lay boards perpendicular to the window, following the direction of the main source of light. For the best result, make sure to always work from 3 to 4 cartons at a time, mixing the planks during the installation.
- Check if subfloor/site conditions comply with the specifications described in these instructions. If you are not satisfied, do not install, and contact your supplier. An installed board with a visible defect is considered as being accepted.
- Flooring products can be damaged by rough handling before installation. Exercise care when handling and transporting these products. Store, transport and handle the flooring planks in a manner to prevent any damage. Store cartons flat, never on edge.
- Flooring products can be heavy and bulky. Always use proper lifting techniques when handling these products. Whenever possible, make use of material-handling equipment such as dollies or material carts. Never lift more than you can safely handle; get assistance.
- Calculate the room surface prior to installation and plan an extra 5-10% of flooring for cutting waste.
- The environment where the flooring is to be installed is critically important with regard to successful installation and continued performance of the flooring products. The

flooring is intended to be installed in interior locations only. These interior locations must meet climatic and structural requirements as well.

- In most cases, this product does not need to be acclimated. However, if the boxes of flooring were exposed over 2 hours to extreme temperatures under 50°F / 10°C or over 104°F / 40°C within the 12 hours before the installation, acclimation is required. In this case, keep the boards in room temperature for at least 12 hours in unopened package before you start the installation. The room temperature must be maintained consistent between: 70-80°F / 20-25°C a humidity range of 35-65% before and during the installation.
- Flooring should only be installed in temperature-controlled environments. It is necessary to maintain a constant temperature of 70-80°F / 20-25°C before and during the installation. Portable heaters are not recommended as they may not heat the room and subfloor sufficiently. Kerosene heaters should never be used.
- After installation, make sure that the flooring is not be exposed to temperatures less than 50°F / 10°C or greater than 120°F / 50°C.
- For floor surfaces exceeding 1064 sq. ft. / 100 m<sup>2</sup> and/or lengths exceeding 33 lineal ft. / 10 m, use expansion moldings.

## II.SUBFLOOR INFORMATION

- Inspect your subfloor before you begin, it must be structurally sound, clean, dry, flat, and smooth. High spots and bumps must be leveled. Deflections more than 1/8" / 3 mm within 6 ft. / 2 m radius must be leveled out with an appropriate leveling compound, the same applies to unevenness of more than 1/32" / 1 mm within 8" / 20 cm.
- Ceramic tile floors, ceramic and marble grout joints, and irregularities in concrete should be filled and leveled.
- Depressions, deep grooves, expansion joints and other subfloor imperfections that exceed 4mm wide & 4mm depth must be filled with patching & leveling compound.
- Substrates must be free from excessive moisture or alkali. Remove dirt, paint, varnish, wax, oils, solvents, any foreign matter and contaminants.
- Do not use products containing petroleum, solvents or citrus oils to prepare substrates as they can cause staining and expansion of the new flooring.
- Although this floor is waterproof, it is not aimed to be used as a moisture barrier. The concrete moisture vapor emissions should not exceed 8 lb / 3.63 kg (ASTM F1869) / 90 % RH (ASTM F2170) with a PH limit of 9 / max. 2.5 % moisture content (CM method).

- This product is also not to be installed in areas that have a risk of flooding such as saunas or outdoor areas.
- Existing sheet vinyl floors should not be heavily cushioned and not exceed more than one layer in thickness. Soft underlayment and soft substrates will diminish the products inherent strength in resisting indentations.

### **CONCRETE SUBFLOORS**

- Existing concrete subfloors must be fully cured, at least 60 days old, smooth, permanently dry, clean, and free of all foreign material such as dust, wax, solvents, paint, grease, oils, and old adhesive residue. Curing agents and hardeners could cause bonding failure and should not be used.
- We recommend using a minimum 6 mil / 0.15 mm poly-film as a moisture barrier between the concrete subfloor and the flooring.

### **WOODEN SUBFLOOR**

- Check the floor for signs of mould and/or insect infestation. Make sure that the screed is levelled and nail down any loose parts. If necessary, apply a levelling floor or levelling compound to optimally prepare the covering floor. It is essential that the crawl space between the floor and the wooden screed is always ventilated. Remove any obstacles and ensure sufficient ventilation (minimum 4 cm<sup>2</sup> total ventilation opening per m<sup>2</sup> of floor). Always check the moisture content of the wooden floor. This may not be more than 14%. *MOISTURE IN THE SUBFLOOR* Although the Area Flooring are insensitive to moisture, they are not intended for use as a moisture-inhibiting or waterproof system. In case of moisture, the screed must be sufficiently dried out or made vapour-tight before the Area floor is installed. Moisture or rising residual moisture under the floor can lead to unhealthy mould formation and/or push up the floorboards with the chance of permanent deformation.

### **DO NOT INSTALL OVER**

Carpet, needle felt, cushion vinyl, floating floors of any kind; parquet, solid and engineered hardwood over concrete; sleeper substrates. Do not install over existing wood flooring glued to concrete.

### **IMPORTANT NOTICE**

In-floor Radiant Heat: Flooring can be installed over 1/2" / 12 mm embedded radiant heat using the floating method. Maximum operating temperature should never exceed 82°F / 28°C. Use of an in-floor temperature sensor is recommended to avoid overheating.

- \* Turn the heat off for 24 hours before, during and 24 hours after installation when installing over radiant heated subfloors.

- \* Before installing over newly constructed radiant heat systems, operate the system at maximum capacity to force any residual moisture from the cementitious topping of the radiant heat system.
- \* Make sure that the temperature in the room is maintained consistent between 70-80°F / 20-25°C before and during the installation.
- \* Floor temperature must not exceed 82°F / 28°C.
- \* If there is a temperature difference of 12°C or more between different rooms, an expansion joint must be provided. This also applies to surfaces where there is underfloor heating in one room and not in the other. These two floor parts can expand differently, with tension as a result.
- \* Once the installation has been completed, the heating system should be turned on and increased gradually (5-degree increments) until returning to normal operating conditions.
- \* Refer to the radiant heat system's manufacturer recommendations for additional guidance.

**WARNING:** Electric heating mats that are not embedded into the subfloor are not recommended for use underneath the floors. Using electric heating mats that are not embedded and applied directly underneath the floors could void the warranty for your floor in case of failure. It is best to install the flooring over embedded radiant floor heating systems and adhere to the guidelines listed above.

## INSTALLATION

- Remove baseboard, quarter-round moldings, wall base, appliances and furniture from room. For best results, door trim should be under-cut to allow flooring to move freely without being pinched. After preparation work, sweep and vacuum the entire work area to remove all dust and debris.
- With a floating floor, you must always ensure you leave a 1/4" / 6 mm gap between walls and fixtures such as pillars, stairs, etc. These gaps will be covered with trim moldings after the floor is installed. Therefore, you may never glue, nail or fix the floor boards to the screed, walls or any other part of the room. Never use a silicone sealant or other flexible paste to fill the expansion joints.
- Whenever possible, plan the layout so that the joints in the planks do not fall on top of joints or seams in the existing substrate. The end joints of the planks should be staggered a minimum of 8" / 20 cm apart. Do not install over expansion joints. Avoid installing pieces shorter than 12" / 30 cm at beginning or end of rows.
- Do not install your kitchen cabinets directly over your floor. The SPC floor's quality can be guaranteed as long as the floor can move freely.

- Decide the installation direction. It is recommended to install the boards perpendicular to the window following the direction of the main source of light.
- MOISTURE BARRIER

In high-moisture areas, such as bathrooms, we recommend applying a water-tight foil (0,2mm) beneath underlayment. Although Area floorings are completely water-resistant, water can always seep in between the joints or beneath the edge of the floor, permeating the underground and causing damage.

Note: The screed must always be completely dry and meet the specified moisture values, even with a moisture barrier!

- Measure the area to be installed: The board width of the last row shall not be less than 2" / 50 mm. If so, adjust the width of the first row to be installed. In narrow hallways, it is recommended to install the floor parallel to the length of the hall.
- UNDERLAY: If the floor does not have a pre-attached underlayment, an additional underlayment is recommended in order to improve acoustic

- Performance and absorb some irregularities on the substrate. Best results can be expected with an underlayment of 0.04" / 1 mm to max 0.06" / 1.5 mm thickness with a high density (>11.2 lbs / >180 kg / m<sup>3</sup>) and high compressive strength (>200kPa) that supports the click system during daily use. Underlayments with a low density and an inadequate compressive strength could damage the locking mechanism and will void warranty.

If the floor has a pre-attached underlayment, the use of an additional underlayment could damage the locking mechanism and will void warranty.

- To minimise shade variation, mix and install product from several different packs alternately. After laying a small quantity of product, view from a distance that allows you to clearly see the overall effect. If there is any doubt cease installation immediately and contact your retailer or Area Floors representative
- From the left corner of the room put the first plank in place using spacer blocks against the walls to maintain the appropriate expansion gap so both the end and side seam grooves are facing outwards. Planks are to be installed from left to right. To assist in laying the first row straight, the use of masking tape across each short and locking system recommended. Continue this for the first two rows and remove after completion of installation.
- Install the second plank in the first row by engaging the tongue of new plank at a 30-degree angle into the indent of previously installed plank. Lock the planks together by lowering the new plank down, ensuring the joint is fitted tightly. There should be no gaps between the planks. Care must be taken to properly line up the end joint and NEVER force the joint while out of alignment, otherwise this could result in permanent damage to the end groove.

- Continue in this manner for the rest of the first row. The last plank in the row should be cut to length while maintaining the appropriate expansion gap along the perimeter of the room or fixed vertical surfaces.

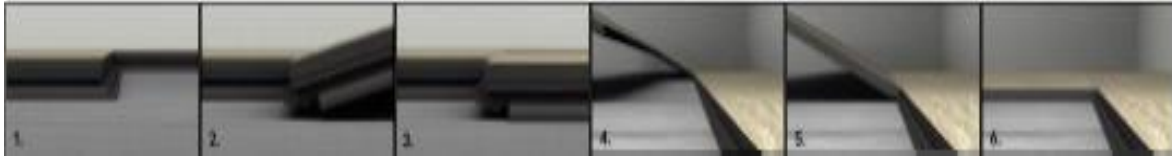

Cut a plank that is at least 200mm shorter than the first plank to start the second row or use the cut off from the previous row, keepig in mind the length requirements. Install the first plank in the second row by inserting the long side tongue into the groove of the plank in the first row at a low angle(30o) to www.arthe installed plank. Then lower the plank while maintaining a slight pressure toward the installed plank. The planks should fit snuglyeafloors.com.tr together and lay flat maintaining the appropriate expansion gap along the perimeter of the room or fixed vertical surfaces.

- To install the remaining planks in the second row, first position the board at a 30-degree angle to the previous board. Leaving a 20mm gap from the previous row of boards. Slide the plank to the left until it meets the previously installed plank, and the short edge tongue fits tightly into the existing boards indent.
- Lower the plank while maintaining a slight pressure towards the installed piece. The planks should fit snugly together and lay flat. Then raise planks in row so they are at a 30-degree angle to the previous row of planks with the tongues fitted tightly into the long edge indents of previous row. Lastly, lower row of planks down so that joints on the short and long edges are engaged. Planks should lay flat with no gaps between previous row or installed plank.
- Work across the length of the room installing planks in the second row. It is critical to keep these first two rows straight and square, as they are the“foundation” for the rest of the installation. Check often for sqareness and straightness while installing the floor as failure to do so can result in gapping.
- Continue installing, being certain to maintain a random pattern repeat, assited by offsetting end joints by at least 150mm. Maintain the appropriate expansion gap against all fixed vertical surfaces.
- Check to be certain all planks are fully engaged; if slight gapping is noticed or the planks will not lay flat, simply disengage the long/top side joint and then carefully slide the short/end joint apart. Do not pull up on this joint as it will damage the locking mechanism! Reinstall the plank.

- The last row(possibly the first row) plank width should be no less than 50mm on the long seam. Remember to allow for the appropriate expansion gap to the wall.
- Holes for pipes: measure the diameter of the pipe and drill a hole that is 20mm larger.
- Install wall mouldings and door transition mouldings last. Be sure that all mouldings are fastened directly to the wall or subfloor; do not place any fasteners through the floating flooring. Care must be taken when fitting wall mouldings that they do not push down on the floor. This will affect the floors ability to expand and contract and may lead to product failure.

## INSTALLATION ILLUSTRATIONS

### How to engage

1:Start by positioning the plank at a 30-degree angle from the existing floorboard.Leave a 20mm gap from boards in the previous row.

2: Slide the angled plank into an existing board

(left).Ensuring the tongue is fitted tightly into the indent of existing board.

3: Lower the new board down gently so it is parallel with existing planks and securely engaged.

4: Position new and existing planks in the row at a 30-degree angle from previous row of boards.

5: Gently slide new plank down so that the tongue of new board is engaged tightly into indent of existing plank in previous row.

6: Lastly , lower all planks down.There should be no gaps between planks.



## FLOOR CARE & MAINTENANCE

SPC floors are durable, but like all interior floor coverings require care periodically to look their best and prevent problems before they occur.

The frequency will depend on your lifestyle and traffic on the flooring over time.

Routine & Preventive Care Do's and Don't's

Sweep, dust mop or vacuum (air suction only) regularly to remove loose dirt and grit. Do not use treated dust mops.

Do not use a steam cleaner on the SPC floor.

Most of the pollution comes from an external source. Avoid entering dirt, water and sand by placing an adapted foot mat, on all entrances. This not only helps to prevent damage to your floor, it also facilitates maintenance and extends the life of your Area flooring. When choosing a floor mat, please note that the backing of the mat does not consist of rubber or latex. These can cause discoloration of the AREA flooring.

Clean up spills or pet accidents immediately

If an additional cleaning product is used, choose a pH-neutral product (pH 7).

Aggressive products can corrode the topcoat of the Area Flooring and cause damage. Never use maintenance products that contain wax or oil. Do not use vinegar, polishes, abrasives, corrosive detergents or solvents.

Avoid exposure to long periods of direct sunlight. Close blinds or drapes during peak sunlight hours.

SPC flooring subjected to excessive heat and light is subject to thermal degradation.

Maintain consistent room temperature of 65°- 85° F and relative humidity levels of 35%-55% at all times.

Do not expose the SPC flooring to temperatures exceeding 110° or temperatures below 32°F.

Ensure that chairs or furniture with casters or wheels are easy swiveling with large surface non-staining casters and suitable for resilient floors use. Do not use ball type casters as they can damage the floor.

Protective mats and chair pads are required under office chairs or furnishings with rolling casters.

Ensure that frequently moved furniture is protected with felt pads to avoid scratching the floor.

Heavy furniture and appliances should be equipped with non-staining large surface floor protectors. Use floor protectors under furniture.

Use mats at entrances to prevent dirt and grit from being tracked on to the floor.



Protect flooring in the kitchen area with a high-quality rug in areas subject to hot oil spills or splatter.

Use non-staining mats only. Rubber may discolor the floor.

Do not use electric brooms with hard plastic bottoms without padding as these may damage the flooring.

## **WARRANTY INFORMATION**

SPC flooring carries a limited 25 year residential warranty and a limited 10 year commercial warranty for wear to the finish under proper usage and maintenance conditions. SPC flooring is guaranteed to be 100% waterproof but spills should be cleaned in a timely manner to prevent the possibility of mold or mildew growth.

The guarantee applies only to the original purchaser and proof of purchase is required for all claims

We warrant to the original purchaser that the wear layer on our flooring:

- Will not wear through the decorative surface. Scratches, indentation or reduction in gloss level is not considered wear.
- Will not stain from normal household consumable items such as food or drink.
- Will not stain from pet (domestic cat or dog) stains, including urine, faeces and vomit, providing it is immediately cleaned upon discovery. Stain resistance means the ability of the floor to resist (i.e. minimize or withstand) permanent stains for the warranty period.
- Will not fade as a result of direct sunlight or household lighting.
- Will be resistant to damage from normal household spills.
- In its original manufactured conditions, will be free from manufacturing defects.

Starting from the date of purchase, but only if no exclusions are applicable and only if all conditions are fulfilled.

We warrant the original purchaser that our flooring:

- Will not delaminate.
- In its original manufactured condition, will be free from manufacturing defects.

Starting from the date of purchase, but only if no exclusions are applicable and only if all conditions are fulfilled.

We warrant to the original purchaser starting from the date of purchase, the floor can be installed over an embedded radiant-heated subfloor, but only if no exclusions are applicable and only if all conditions are fulfilled:

- In-floor Radiant Heat: flooring can be installed over 1/2" / 12 mm embedded radiant heat using the floating method.
- Electric heating mats that are not embedded into the subfloor are not recommended for use underneath the flooring. Using electric heating mats that are not embedded and applied directly underneath the flooring could void the warranty in case of failure.
- The radiant heating system must incorporate electronic temperature controls.
- Heat must be off for 24 hours before, during and 24 hours after installation when installing over radiant heated subfloors.
- Before installing over newly constructed radiant heat systems, operate the system at maximum capacity to force any residual moisture from the cementitious topping of the radiant heat system.
- Concrete moisture vapor emissions should not exceed 8 lb / 3.63 kg (ASTM F1869) / 90 % RH (ASTM F2170) with a PH limit of 9 / max 2.5 %moisture content (CM method).
- Please respect the temperature range in the room before and during the installation as specified in the installation manual, or your warranty will be void.
- Once the installation has been completed, the heating system should be turned on and increased gradually (5-degree increments) until returning to normal operating conditions.
- Floor temperature must not exceed 85°F / 30°C.
- Refer to the radiant heat system's manufacturer recommendations for additional guidance.

We warrant that spc flooring in its original manufactured state to the original purchaser from the date of purchase, under normal and reasonable use, and the surface, when properly installed, shall be resistant to damage from mopping or normal household spills. This means planks or tiles will not swell, buckle or lose integrity. The moisture warranty does not cover flooding, leaking pipes, household mechanical failures, appliance leaks. Any damage to the subfloor and/or surrounding structure that is caused by standing water or flooding is not covered by this warranty.

We warrant that the floor will resist staining caused by pet (domestic cat or dog) stains, including urine, feces, and vomit. Stain resistance means the ability of your floor to resist (i.e., minimize or withstand) permanent stains for the warranty period. However, accidents should be cleaned up immediately (within 24 hours), as the longer they sit, the more difficult they will be to remove. Any damage to the subfloor and/or surrounding structure caused by pets is not covered by this warranty.

## EXCLUSIONS

For jobsite and floor preparation conditions, see product specific installation guidelines.

Any moisture related testing (i.e. relative humidity, pH, and calcium chloride) is the responsibility of the installer.

The following are not covered by this Limited Warranty:

- Improper use of the flooring product to seal an existing floor from moisture. SPC flooring is a waterproof floating floor that comes with an attached underlayment pad, but is not intended to act as a moisture barrier.

- This Limited Warranty is void if, prior to installation in commercial and light commercial applications this flooring is not acclimated to room temperature

(between 65°F and 85°F) at the job site for a minimum of 24 hours and, if post installation (in all applications) such flooring is not continuously maintained at such temperature.

- Damage caused by any of the following:

Fire, burns. Flooding. Subfloor moisture emissions. Alkali emissions. Vacuum cleaner beater bar. Intentional or accidental abuse.

Castor chairs/rolling loads – use chair pads under castor desk/rolling chairs. Moving heavy appliances. Cuts or gouges from sharp objects

- Surface scratches unless covered by a scratch warranty

- Residual indentations or gouges resulting from heavy static loads, heeled shoes, spiked shoes, metal cleats or skates. Use floor protectors under stationary furniture legs/feet to distribute weight loads

- Changes in color or appearance resulting from, but not limited to, sunlight exposure or heat exposure

- Changes in shade, texture, or gloss over time

- Outdoor applications

- Minor shading, color, or texture difference between the store samples or marketing photography and delivered product

- Performance failures resulting from failure to follow the appropriate installation instructions

- Damage resulting from failure to follow care and maintenance guidelines including, but not limited to, use of non-approved cleaning agents

or abrasive scouring pads

- Product installed in commercial food preparation areas and underneath food preparation tables.

- Stains resulting from, but not limited to, spills, mold, chemically reactive materials, adhesives
- Losses due to inconvenience, loss of time, incidental expenses, or consequential damages

This warranty excludes all casualty events normally covered by homeowners insurance including, but not limited to, damages caused by fire, flooding, or standing water from leaking plumbing, faucets, or household appliances.

Spc floors are not warranted against squeaking, popping or crackling. Some squeaking, popping, or crackling is possible when installed using floated methods

### **WHAT IF YOU NEED WARRANTY SERVICE**

You, the original purchaser, will contact your authorized Company Dealer and/or Sales Representative for warranty or claim service.

Please provide a valid proof of purchase and a detailed description of the issue, along with photographs showing the concern. Samples should be submitted for testing when available.

Dealers/Area Sales Representatives will file a claim via [www.areafloors.com.tr](http://www.areafloors.com.tr) and submit the information you provided. Areafloors claims representative will thoroughly evaluate your claim.

### **WHAT WE WILL DO**

Replacement resilient will come from current running-line products comparable to the warranted product.

- Within Two Years: Claims on defects of this product as covered by this warranty that are reported in writing within two year of purchase,AREAFLOORS will arrange a credit based on the original purchase of the product or replace the product. If professionally installed and have lisencc, reasonable labor costs are included.
- After Year Two: Claims on defects of this product, as covered by this warranty, that are reported in writing after two years of purchase and within the specified warranty coverage term, AREAFLOORS will arrange a credit based on the original purchase of the product or replace the product.

Labor costs are not included.

Should a defect covered under this warranty be found, the affected area will be repaired to conform to the warranty. If repair is not practical, the Company may, at its sole option, replace the affected resilient or refund the proportional purchase price for the affected area. The Company will pay the reasonable costs for freight and labor. Any additional costs incurred will be at the consumer's expense.This warranty is limited to the designs, colours,

structures and styles available at the time of repair or replacement. If the original is no longer available, we have the right to substitute another design, colour, structure and style that is similar to the original and that has a similar value. We will always try to take into account the wish of the customer.

NOTE: The warranty is not transferable. It extends only to the original owner occupied end-use purchaser. Areafloors does not grant to any person or entity the authority to create for it any obligation or liability in connection with this product. Areafloors shall not be liable to the consumer or any other person or entity for any incidental, special or consequential damages, arising out of breach of this limited warranty or any implied limited warranty

(excluding merchantability).

All implied warranties, including an implied warranty of merchantability or fitness for a particular purpose, are hereby limited to the duration of this limited warranty. Some Countries do not allow the exclusion or limitation of implied warranties or the limitation of incidental or consequential damages, so the above limitations or exclusions may not apply to the purchaser. This warranty gives the purchaser specific legal rights, such rights may vary from Country to Country.



[WWW.AREAFLOORS.COM.TR](http://WWW.AREAFLOORS.COM.TR)